

FOSROC

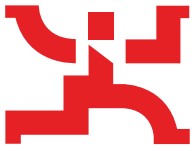

constructive solutions

ROAD & BRIDGE CONSTRUCTION SOLUTIONS





Sea Cliff Bridge, NSW
 Products used: Fosroc Dekguard S

About Fosroc and Parchem

Fosroc is a world leader in construction solutions. Since the company's beginnings over 80 years ago, Fosroc has developed into an international leader in delivering construction solutions for virtually any building or infrastructure project. New or old construction above or below ground, we combine high quality products, expert technical support, customer service and innovation to give you the best solution for your project.

We provide construction solutions for; new and old concrete repair, grouts, waterproofing, joint fillers & sealants, industrial flooring, protective coatings, surface treatments and concrete additives.

Fosroc has an extensive network of offices and manufacturing locations across Europe, the Middle East, India and Asia, and is further represented in other regions across the world by distributor and licensee partners.

Parchem Construction Supplies, part of DuluxGroup, is the licensed manufacturer and distributor of Fosroc, Vector®, Vandex®, and EdenCrete® products in Australia, and Concrete Plus™ is the licensed distributor in New Zealand.

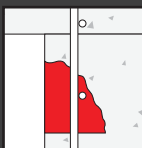

Concrete Repair

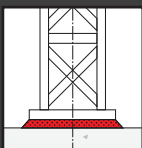

Grouts

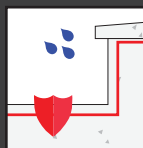

Waterproofing

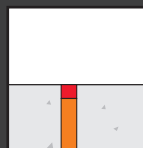

Joint Fillers & Sealants



Industrial Flooring

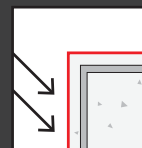

Protective Coatings



Surface Treatments



Concrete Additives

Road & Bridge Construction Solutions



✓ Roads



✓ Bridge bearings



✓ Bridge structures



✓ Bridge piles



✓ Bridge decks



✓ Pre-cast concrete



✓ Pedestrian bridges



✓ Anchoring fixtures

Our Range

Fosroc offers a comprehensive range of construction solutions for road and bridge projects. Whether it is waterproofing for bridge decks, protective coatings for support structures or anchoring of fixtures, Fosroc will work with you to tailor the right solution for your project.

Solutions can be tailored to projects of any size and scale, for new structures, pre-cast elements or remedial work.

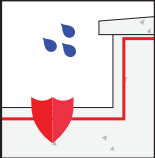
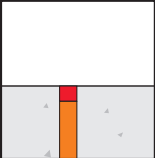
Product	Product	Type	Description	General Advantages	Typical applications
 <p>Waterproofing</p>	Proofex Torchseal A900	Torch applied membrane	Torch applied waterproofing membrane specifically designed for bridge decks that will receive hot rolled asphalt. 5mm thick, reinforced elastoplastomeric polymer with high puncture resistance, excellent mechanical resistance and joint cut resistance.	Can be overlaid with hot asphalt.	Bridge decks.
	Proofex 6100	Self adhesive membrane	Self adhesive, bituminous waterproofing membrane incorporating a polypropylene mesh for added strength, puncture resistance and heat stability. Suitable for the application of hot asphalt up to 165°C directly over the membrane.	Self adhesive. Can be overlaid with hot asphalt.	Asphalt roads, pavements & bridge decks.
	Nitoproof range	Liquid applied membrane	Fosroc offers a comprehensive range of liquid applied waterproofing membranes, contact your local Fosroc Representative for product recommendations.		Waterproofing.
 <p>Joint Fillers & Sealants</p>	Nitoseal SC800	Silicone joint sealant	Trafficable, low modulus, high joint movement accommodation, silicone rubber joint sealant with Roadseal Technology. Excellent UV & weather resistance. Accepted for NSW RMS and QLD Main Roads use. Colour: Concrete Grey.	Prevents running water from undermining pavements. Prevents stones from being deposited in joints.	Roads, pavements & bridge decks.
	Nitoseal SC820	Silicone joint sealant	Trafficable, very low modulus, high joint movement accommodation, self-smoothing, silicone joint sealant for sawn joints in concrete and asphalt pavements. Fast curing, excellent UV & weather resistance. Colour: Charcoal Grey	Excellent adhesion to clean dry concrete and sawn asphalt.	Asphalt roads & pavements.
	Thioflex 600	Polysulphide joint sealant	Trafficable, fuel resistant, fast curing, two-component polysulphide joint sealant with high movement accommodation. Forms a tough, elastic, rubber-like seal with excellent durability. Available in gun grade and pouring grade. Colour: Grey.	Fuel resistant.	Roads & pavements.
	Nitoseal range	Joint sealants	Fosroc offers a comprehensive range of sealants, contact your local Fosroc Representative for product recommendations.		Sealing joints.

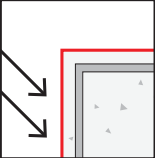
Product	Product	Type	Description	General Advantages	Typical applications
 <p>Protective Coatings</p>	Dekguard S	Protective coating	Aliphatic acrylate, solvent based protective coating to protect atmospherically exposed reinforced concrete structures from attack by chloride ions and water. Excellent UV and weather resistance. Suitable for new and existing structures.	Suitable for marine and coastal environments.	Non-trafficable concrete surfaces.
	Dekguard E2000	Protective coating	Elastomeric, pigmented, water based acrylic protective coating to protect atmospherically exposed reinforced concrete structures from attack by chloride ions, oxygen and water, especially where there is a danger of subsequent cracks appearing within the substrate. True elastomeric coating with excellent elongation and recovery properties. Excellent UV and weather resistance. Available in a range of colours.	Can accommodate substrate cracking. Suitable for use in coastal environments.	Non-trafficable concrete surfaces.
	Dekguard Elastic	Protective coating	Crack accommodating, elastomeric, pigmented, water based acrylic protective coating to protect atmospherically exposed reinforced concrete structures from attack by chloride ions, oxygen and water, especially where there is a danger of subsequent cracks appearing within the substrate. True elastomeric coating with excellent elongation and recovery properties. Excellent UV and weather resistance. Available in a range of colours.	Accommodates cracks up to 6 mm and cyclic movement up to 1 mm.	Non-trafficable concrete surfaces.
	Nitocote SN508 Crème	Silane based sealer	Thixotropic, water dispersed emulsion of iso-octyltriethoxysilane to protect concrete from water and chloride ingress, while still permitting water vapour transmission out of the structure. Cream consistency helps to prevent drips and runs, and makes it ideal for windy conditions and elevated temperatures. Can be used for new or existing structures.	Ideal for windy conditions and elevated temperatures. Produces a water beading effect.	Non-trafficable concrete surfaces.
	Nitocote SN511	Silane based sealer	A deeply penetrating silane based treatment designed to protect concrete from both water and chloride ingress while still permitting water vapour transmission out of the structure. Can be used for old or dense concrete.	Ideal for marine and coastal environments. Produces a water beading effect.	Non-trafficable concrete surfaces.

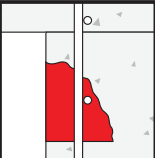
 <p>Concrete Repair</p>	Renderoc range	Patch repair mortars	Fosroc offers a comprehensive range of concrete repair solutions including options where galvanic anodes are required, classified RCS hazard free*. Contact your local Fosroc Representative for product recommendations.		Vertical and overhead structural repairs.
	Guncrete E	Spray applied repair mortar	High strength, low shrinkage, high build dry-spray applied repair mortar. Low rebound, can be applied in sections from 10mm up to 150mm depending on substrate geometry. Can be applied by standard dry-spraying techniques. Suitable for galvanic repairs.	Classified RCS hazard free*. Can be used with Vector Corrosion Technologies for galvanic repairs.	Vertical, overhead or horizontal structural repairs.
	Renderoc BB	Bearing mortar	High strength gain, low shrinkage mortar for the installation of elastomeric bridge bearings. Contains sufficient coarse aggregate to provide a rough finish on the surface supporting the bearings.	Rapid strength gain. Classified RCS hazard free*.	Installation of elastomeric bridge bearings.



For galvanic repairs, choose from our range of Vector®, Galvashield® or Galvanode® corrosion protection technologies that have been tested and proven for use with the Fosroc Renderoc range. Parchem is the licensed distributor of Vector Corrosion Technologies products in Australia, and, Concrete Plus is the licensed distributor in New Zealand.

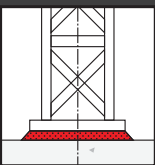
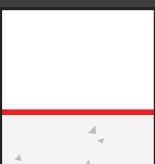

*Contains <0.1% respirable crystalline silica [RCS].

Product	Product	Type	Description	General Advantages	Typical applications
 <p>Grouts</p>	Conbextra CB	Cementitious grout	High flow, high strength, Class A pumpable cementitious grout. High early strength development allows early tensioning of cables. Excellent pumpability over both flowable and thixotropic consistencies.	High strength development. Classified RCS hazard free*.	Void filling.
	Conbextra CB-C	Cementitious grout	High flow, Class A/Class C dual shrinkage compensated cable bolt grout. High early strength development allows early tensioning of cables. Non-shrink according to ASTM C1107:2020. Excellent pumpability over both flowable and thixotropic consistencies.	Dual shrinkage compensated. Classified RCS hazard free*.	Void filling.
	Conbextra EP65 Plus	Epoxy grout	Ultra high strength, high flow epoxy grout for anchoring vertical starter bars and other vertical anchoring applications such as hold down bolts. Very high compressive, tensile and flexural strengths. Low creep characteristics under sustained loading. High early strength development.	Very high compressive, tensile and flexural strengths.	Anchoring roadside barriers.
	Conbextra range	Construction grouts	Fosroc offers a comprehensive range of grouts including cementitious and epoxy, thixotropic and pumpable grades. Contact your local Fosroc Representative for product recommendations.		Filling voids.
	Nitomortar AP	Epoxy paste	Multi purpose, epoxy adhesive repair paste, also used as an adhesive for the Nitofill LV crack injection system. Used for speedy and permanent patching repairs, bonding of precast concrete components and repair work where strength, impermeability to water, and resistance to aggressive chemicals is essential. The thixotropic nature of Nitomortar AP makes the product ideal for setting starter bars, dowels, holding down bolts and anchoring in general.	Thixotropic. Excellent abrasion and impact resistance.	Permanent patch repairs, emergency repairs and adhesive for Nitofill LV.
	Nitofill PU130	Hydrophobic polyurethane grout	Multi-purpose hydrophobic polyurethane injection grout which is mixed with nominated levels of accelerator to initiate expansion in the product to seal leaking cracks and joints in concrete and fill voids in generally inaccessible locations.	Withstands high hydrostatic pressure.	Seal leaking cracks, failed joints, or, fill large voids and fractures in concrete structures.
	Nitofill PU150	Hydrophilic polyurethane grout	Multi-purpose hydrophilic polyurethane injection resin with high elongation and flexibility. Reacts with available water to initiate expansion in the product to seal leaking cracks and joints in concrete and fill voids in generally inaccessible locations.	Reacts with sea water or mineral water.	Pump directly into small leaking cracks, fractures or joints in concrete.
	Nitofill LV	Epoxy crack-injection system	High strength, low viscosity, epoxy resin injection system designed for injecting into cracks in concrete and masonry to consolidate a structure or exclude water and air from contact with the reinforcement. It is ideal for small scale crack repairs on site, suitable for insitu or precast concrete elements.	Penetrates very fine cracks.	Small scale structural crack repairs.
 <p>Surface Treatments</p>	Preco Bondbreaker	Mould release agent	Mould release agent designed for use in prefabricated or "tilt-up" panel construction. It will significantly reduce surface defects including blowholes in concrete finish and ensures easy demoulding to architectural quality standards. Non-staining, protects moulds from corrosion and water damage.	Can be used with most types of moulds.	Prefabricated or "tilt-up" panel construction.
	Preco Form Crème	Mould release agent	Non-drip, long lasting release agent for application to steel hinges or timber formwork. Prevents concrete penetration into steel hinges and rust staining. Resists transfer of splinters from formwork. Resists exposure to weather for several days prior to a concrete pour.	Non-drip & long lasting.	Prefabricated or "tilt-up" panel construction.
	Concure range	Curing compounds	Fosroc offers a comprehensive range of curing compounds, contact your local Fosroc Representative for product recommendations.		Curing concrete and repair mortars.



FOR TOUGHER STRONGER CONCRETE



Developed by Eden Innovations LLC, EdenCrete® is a carbon nanotube-enriched liquid additive that elevates concrete structures to new levels of strength and toughness. When added to concrete mixtures, it performs like multiple additives rolled into one. It boosts surface abrasion resistance and produces extremely low permeability while improving strength properties [i.e., compressive, flexural, and split-tensile] like no other product on the market today. EdenCrete is ideal for use in new concrete for road and bridge projects.

Parchem is the licensed distributor of EdenCrete products in Australia, and, Concrete Plus is the licensed distributor in New Zealand.

*Contains <0.1% respirable crystalline silica [RCS].



FUTURE PROOF

**WITH FOSROC
ROAD & BRIDGE
CONSTRUCTION
SOLUTIONS**





constructive solutions

World leaders in construction solutions

Fosroc is a world leader in the delivery of virtually any type of construction project, combining high quality products, expert technical support, customer service and innovation.

AU 1800 812 864 fosroc.com.au

NZ 0800 657 156 fosroc.co.nz

Parchem Construction Supplies Pty Ltd 1956 Dandenong Rd, Clayton VIC AUS 3168

Concrete Plus Ltd 150 Hutt Park Road, Gracefield, NZ 5010



* Fosroc, the Fosroc logo, Cemtop, Conbextra, Concure, Nitoflor, Dekguard, Nitoseal, Proofex, Supercast, and Renderoc are trade marks of Fosroc International Limited, used under licence. Guncrete, Nitocote, Nitomortar, Nitofill, Nitoproof and Preco are trade marks. Galvanode and Vector are trade marks, used under licence.

Eden Innovations LLC is a wholly owned subsidiary of Eden Innovations LTD, Perth, Australia. Edencrete, the Edencrete logo is a registered trade mark of Edencrete, used under license.

C.I. Takiron and Hydrotite are registered trademarks.

Project images are representations of the types of projects these products can be used for.